

Planning your functions at Embassy Suites Kansas City Plaza is straight-forward! We offer a unique setting; attractive amenities; 'distinctive dining' offerings you'll be surprised to find in a hotel; welcoming staff offering personal service and genuine hospitality; and, most importantly... **VALUE!**

We offer 11,000 square feet of flexible space, conveniently consolidated on the hotel's second floor. Function spaces are window lined allowing pleasant, energizing natural light into the space! And, the rooms open to a 2nd Floor Balcony overlooking our center-court fountain and 12-story atrium.

Here are some tools to make your decision making, budgeting and planning processes easy.

EMBASSY SUITES HOTEL KANSAS CITY-PLAZA -SECOND FLOOR

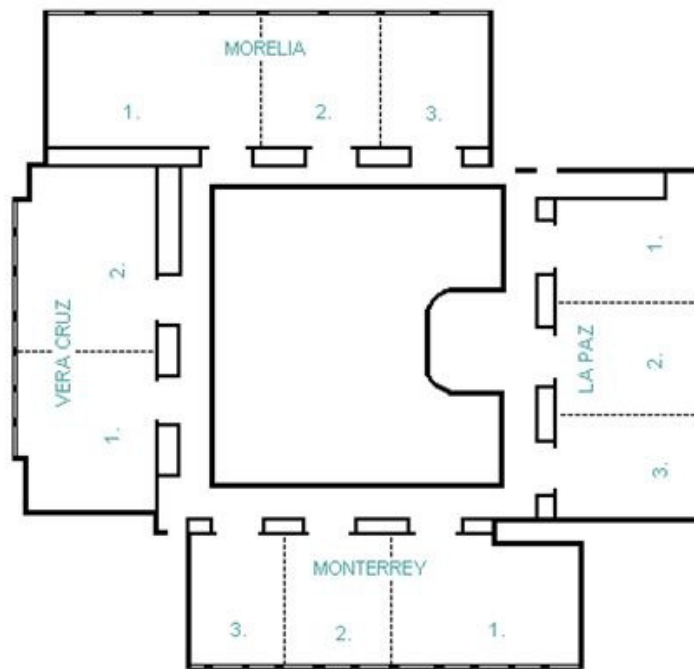

Room	Dimensions	Square Footage	Ceiling Height	Classroom 3/6'	Theater	Rounds of 8	U-Shape	Reception
Morelia	112 x 30	3360	10	200	320	220	N/A	260
Morelia 1	55 x 30	1650	10	110	160	104	45	150
Morelia 2	29 x 30	870	10	45	80	48	24	50
Morelia 3	28 x 30	840	10	36	70	48	24	50
Monterrey	100 x 30	3000	10	170	280	180	N/A	230
Monterrey 1	43 x 30	1290	10	75	130	88	35	80
Monterrey 2	29 x 30	870	10	45	80	48	24	50
Monterrey 3	28 x 30	840	10	36	70	48	24	40
LaPaz	73 x 32	2336	10	110	220	140	45	150
LaPaz 1	19 x 32	600	10	24	60	24	15	N/A
LaPaz 2	29 x 32	928	10	54	90	48	24	60
LaPaz 3	25 x 32	800	10	36	65	40	21	40
Vera Cruz	78 x 32	2496	10	120	300	140	45	150
Vera Cruz 1	39 x 32	1248	10	55	150	64	30	70
Vera Cruz 2	39 x 32	1248	10	55	150	64	30	70

All Prices Subject to a Customary 21% Taxable Service Charge and Applicable Taxes.



Unique Location. Distinctive Dining. Genuine Hospitality.



All Prices Subject to a Customary 21% Taxable Service Charge and Applicable Taxes.

220 W 43rd Street | Kansas City, MO 64111 | 816.204.3709 p | 816.531.1823 f
kansascityplaza.embassysuites.com



THE PLAZA CORPORATE MEETING PACKAGE

In Addition to Food and Beverage, Your Package Includes Complimentary:
General Session Room
Screen and Powered AV Table

Complimentary Self-Parking OR Complimentary Standard Wireless Internet*

Pre-Meeting

The Executive Continental*

Greet Your Meeting Attendees with our Continental Break
Assortment of Gourmet Pastries, Filled Croissants, Muffins and Breakfast Breads
Sliced Fresh Seasonal Fruit Display
Assorted Fruit Juices, Starbucks® Regular Coffee, Decaffeinated Coffee, Tazo® Hot Tea

Mid-Morning

Refresh Coffee and Tea

Lunch

Select from Any Lunch Buffet

Afternoon Break

Chef's Assortment of Sweets
Lemonade and Iced Tea

\$64.00++ Per Person

Minimum of 25 People | Small group fee of \$75++ for groups with less than 25 guests

ENHANCEMENTS

Hot Breakfast Sandwich or Wrap Minimum Order of 12	\$4.00	each
Bottled Water, charged on consumption	\$3.25	each
Assorted Sodas, charged on consumption	\$3.00	each
Red Bull, charged on consumption	\$4.00	each
Salty Afternoon Snack Housemade Kettle Chips, Pretzels, Snack Mix, Popcorn	\$2.00	per person
Upgrade to Themed PM Break	\$6.00	per person

**If your guests are staying in the hotel and utilizing of our daily Complimentary Breakfast, the Executive Continental can be offered as an AM Break, with Pre-Meeting beverages only.*

All Prices Subject to a Customary 21% Taxable Service Charge and Applicable Taxes.



LUNCH OPTIONS

KC Cattleman's Buffet

Potato Salad and Coleslaw
House-Smoked Beef Brisket
Mesquite Grilled Chicken Breast
Baked Beans, Cheesy Creamed Corn
Cornbread and Whipped Honey Butter
Bread Pudding with Caramel Sauce and Whipped Cream

Taste Of Italy

Traditional Caesar Salad, Salad Niçoise
Cavatappi with Italian Sausage Marinara
Parmesan Crusted Chicken
Penne Alfredo
Italian Roasted Zucchini
Garlic Herb Bread
Chef's Selection of Dessert to Include Tiramisu

All American Cook-Out

Yukon Gold Potato Salad, Cole Slaw
Hamburgers
Grilled Bratwurst with Sauerkraut
Lettuce, Tomato, Onions, Pickles, Relish and Buns
Baked Beans
Assorted Dessert Bars

Deli Buffet

Soup du Jour
Fruit Salad, Potato Salad, Cole Slaw
Sliced Ham, Turkey, Roast Beef, Salami
Assorted Sliced Cheeses, Lettuce, Tomato, Onions and Pickles
Variety of Breads and Rolls
Assorted Cookies and Brownies

Energy Pack

Granola Bars and Trail Mix
Whole Fresh Fruit
Assorted Individual Yogurts
Assorted Fruit Juices Served in Carafes

Southwest Fiesta

Tortilla Chips, Pico De Gallo,
Salsa, Guacamole, Black Bean Salsa,
Chipotle Salsa
Non-alcoholic Margarita Punch

Sweet Street

Assorted Cookies Brownies and
Assorted Dessert Bars
Starbucks® Coffee, Tazo® Hot Tea

La Fiesta

Mixed Greens Salad with Salsa Ranch
Grilled Chicken and Steak Fajitas with
Sautéed Onions and Sautéed Peppers
Shredded Lettuce, Cheese, Sour Cream and
Housemade Salsa
Flour Tortillas
Fiesta Zucchini – Zucchini, Tomatoes, Black Beans
and Corn with Cilantro, Lime and Cumin
Spanish Rice
Cinnamon Sugar Churros Drizzled with Honey

Greek Islands

Greek Salad to include Crisp Romaine Lettuce,
Tomato, Red Onions, Cucumber, Kalamata
Olives and Feta Cheese. Greek Vinaigrette.
Orzo Salad
Variety of Hummus
Chicken Gyros with Greek Marinated Chicken
Breast
Sliced Onion, Tomato, Tzatziki Sauce and
Warm Grilled Pita Bread
Lemon-Oregano Baked Tilapia
Traditional Baklava

Midwest Comfort

Mixed Greens Salad
Pasta Salad
Roasted Chicken Breast with White Wine
Pan Sauce
Sliced Sirloin with Roasted Tomato Demi-Glaze
Choice of Mashed Potatoes or Spinach Potato
Gratin
Chef's Seasonal Vegetable
Chef's Dessert

UPGRADE PM BREAK OPTIONS

Death by Chocolate

Chocolate Drizzled Pretzels, Double-
Fudge Brownies, Chocolate Macaroons
and Marble Chocolate-Chip Pound Cake
Starbucks® Regular and Decaf Coffee

Health Club

Build your own Parfait with Low-Fat
Vanilla Yogurt, Fruit Medley, Granola
and Chopped Nuts
Orange Juice Spritzer

Afternoon Tea

Variety of Traditional Finger Sandwiches
and Bite Size Sweets, including
Housemade Shortbread
Tazo® Hot Tea, Fruit Infused Iced Tea

Home Run

Crackerjacks, Peanuts and Popcorn
Frozen Chocolate Malts
"Pitchers" of Root Beer

Cheese Boutique

Assorted Cheeses Presented with
Seasonal Crudités, Crackers and
Ranch Dip
Sparkling Raspberry Tea

Kid in a Candy Store

Variety of Chocolate, Gummy, Hard
and Chewy Candies to satisfy
anyone's Sweet Tooth!
Variety of Nostalgic Bottled Sodas

All Prices Subject to a Customary 21% Taxable Service Charge and Applicable Taxes.



MEETING PLANNERS QUICK PICK

Includes Complimentary General Session, Screen, Powered AV Table and Wireless Internet for the Speaker

Pre-Meeting

Assortment of Pastries, Muffins and Breakfast Breads
Starbucks® Regular Coffee, Decaffeinated Coffee, Tazo® Hot Tea

Mid-Morning

Refresh Beverages

Boxed Lunch

Gourmet Deli Sandwich Served on a Variety of Breads
Choice of Turkey, Ham, Roast Beef, Veggie Wrap with Cheddar or Swiss Cheese
Pasta Salad, Yukon Gold Potato Salad, Fruit Salad or Housemade Potato Chips
Chef's Choice Dessert
Assorted Soft Drinks and Bottled Water

Afternoon Break

Assorted Jumbo Cookies and Brownies
Lemonade and Iced Tea

\$49.00++ Per Person

Minimum of 25 People | Small group fee of \$75++ for groups with less than 25 guests

ENHANCEMENTS

Hot Breakfast Sandwich or Wrap Minimum Order of 12	\$4.00	each
Bottled Water, charged on consumption	\$3.25	each
Assorted Sodas, charged on consumption	\$3.00	each
Red Bull, charged on consumption	\$4.00	each
Salty Afternoon Snack Housemade Kettle Chips, Pretzels,	\$2.00	per person
Assorted Sodas, charged on consumption	\$3.00	each
Red Bull, charged on consumption	\$4.00	each
Salty Afternoon Snack Housemade Kettle Chips, Pretzels, Snack Mix, Popcorn	\$2.00	per person
Upgrade to Themed PM Break	\$6.00	per person

~~~~~  
**Price is reflective of a Working Lunch. Additional charges may apply should a separate room be required. Additional menu selections available at an additional charge, to include Plated and Buffet Selections.**

All Prices Subject to a Customary 21% Taxable Service Charge and Applicable Taxes.



## HALF-DAY MEETING PACKAGE

In Addition to Food and Beverage, Your Package Includes:  
General Session Room for up to 5 Hours | Screen and Powered AV Table

**\$28.00++ Per Guest**

Minimum of 25 People | Small group fee of \$75++ for groups with less than 25 guests

---

### **Rise and Shine! | Morning Meeting Package**

#### **Pre-Meeting\***

Available for 30 Minutes of Service.

Greet Your Meeting Attendees with Our Continental Break

Assortment of Gourmet Pastries, Filled Croissants, Muffins and Breakfast Breads

Sliced Fresh Seasonal Fruit Display

Assorted Fruit Juices, Starbucks® Regular and Decaffeinated Coffee, Tazo® Hot Tea

#### **Mid-Morning Break**

Refresh Coffee and Tea

\*If your guests are staying in the hotel and partaking of our daily Complimentary Breakfast, Breakfast Food Items can be modified to a Mid-Morning Snack!

---

### **'Not a Morning Person' | Afternoon Meeting Package**

#### **Pre-Meeting**

Iced Tea, Starbucks® Regular and Decaf Coffee, Tazo® Hot Tea

#### **Mid-Afternoon Break**

Select ONE of the Following. Available for 30 Minutes of Service.

##### **Energy Pack**

Granola Bars and Trail Mix  
Whole Fresh Fruit  
Assorted Individual Yogurts  
Assorted Fruit Juices Served in Carafes

##### **Death by Chocolate**

Chocolate Drizzled Pretzels, Double-Fudge Brownies, Chocolate Macaroons and Marble Chocolate-Chip Pound Cake  
Starbucks® Regular and Decaf Coffee

##### **Home Run**

Crackerjacks, Peanuts and Popcorn  
Frozen Chocolate Malts  
"Pitchers" of Root Beer

##### **Southwest Fiesta**

Tortilla Chips, Pico De Gallo, Salsa, Guacamole, Black Bean Salsa, Chipotle Salsa  
Non-alcoholic Margarita Punch

##### **Health Club**

Build your own Parfait with Low-Fat Vanilla Yogurt, Fruit Medley, Granola and Chopped Nuts  
Orange Juice Spritzer

##### **Cheese Boutique**

Assorted Cheeses Presented with Seasonal Crudités, Crackers and Ranch Dip  
Sparkling Raspberry Tea

##### **Sweet Street**

Assorted Cookies Brownies and Assorted Dessert Bars  
Starbucks® Coffee, Tazo® Hot Tea

##### **Afternoon Tea**

Variety of Traditional Finger Sandwiches and Bite Size Sweets, including Housemade Shortbread  
Tazo® Hot Tea, Fruit Infused Iced Tea

##### **Kid in a Candy Store**

Variety of Chocolate, Gummy, Hard and Chewy Candies to satisfy anyone's Sweet Tooth!  
Variety of Nostalgic Bottled Sodas

#### **ENHANCEMENTS**

|                                                |        |      |
|------------------------------------------------|--------|------|
| Hot Breakfast Sandwich or Wrap   Minimum of 12 | \$4.00 | each |
| Bottled Water, charged on consumption          | \$3.25 | each |
| Assorted Sodas, charged on consumption         | \$3.00 | each |
| Red Bull, charged on consumption               | \$4.00 | each |

All Prices Subject to a Customary 21% Taxable Service Charge and Applicable Taxes.

